

## Protocols/Guidelines for Lone Star College – Montgomery Campus

### Location:

3200 College Park Dr.

Conroe, TX 77384

- The morning of the event (Friday and Saturday), before entering campus, complete the online form at the following link. Every person entering campus must do so (one person per form).
  - <https://www.lonestar.edu/montgomery-operations.htm>
    - Scroll mid-way down until you see the box - **Visitor Health Form**
    - Click on the box and then fill out the form.
    - The link is connected to the date each day; therefore, it changes.
    - You will not be able to access the form until 12:01 a.m. the day you plan to be on campus.**
    - You will need to do this each day you are on the campus.**
  - Organization Name: District 9 4-H
  - Campus Visiting: Montgomery
  - Kiosk Location – MC-B
- Drive onto campus through Entrance #3 (the west drive).



- Go all the way down the west drive until you are just past the construction and turn into the Montgomery parking garage. (DO NOT park in the Sam Houston garage. DO NOT park at the University Center.)
- Walk into the west doors of Building B.
- Go through the checkpoint:
  - Get a mask if you do not have one.
  - Go to the first open check-in station.
  - Scan your temperature on the screen.
  - Answer the questions from the check-in person.
  - Take a sticker dot and wear it so it is visible.

## Building B – Entry Flow

April 2021

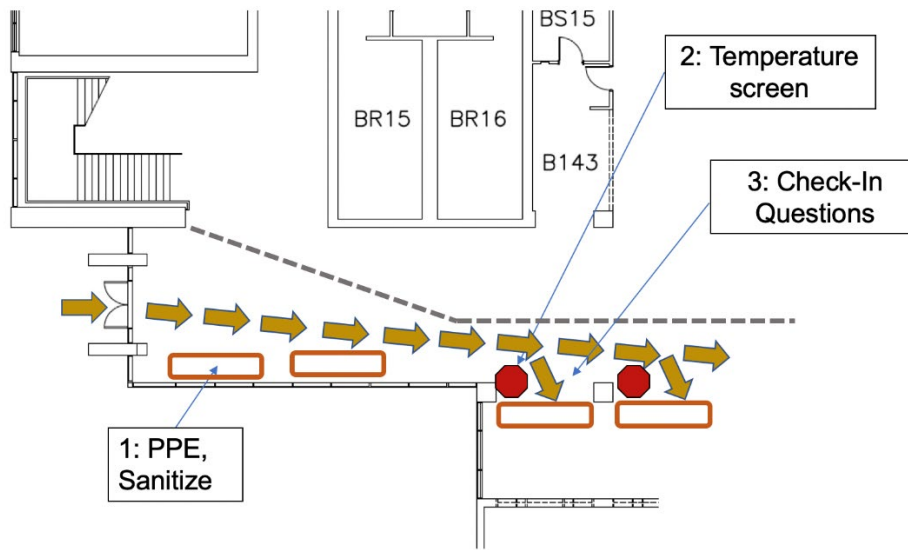

### Some additional notes:

- If the health declaration is filled out ahead of time (no earlier than 12:01 a.m. the day you are on campus) check-in normally takes under a minute per person.
- The sticker of the day must be worn at all times on campus. You might be asked to show it.
- A mask must be worn at all times on campus – inside and outside buildings.

**\*\*Once you have completed check in with Lone Star College, you will check in at the District 9 4-H Table (right next to the Lone Star Check In located on the First Floor of Building B.**